

Tri-Head - Metric Machine Screws

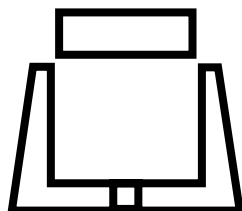

Dimensions (mm)

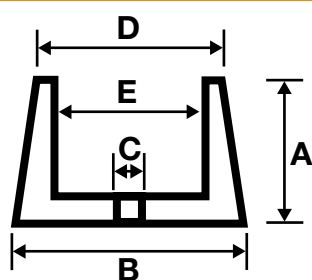

LENGTH SIZE	A	B	C	D	E
M5	12.0	20.0	5.4	18.0	12.9
M6	13.0	22.0	6.4	20.0	15.0
M8	14.0	28.4	8.4	26.0	20.0
M10	18.0	31.8	10.4	30.0	25.3
M12	20.0	35.8	12.4	32.0	26.5

Material and Finish

Material: EN1A Steel
Heat Treatment: Case Hardened
Finish: Bright Zinc Plated 3µm



Material Specification	
Raw Material	Case Hardness
Steel EN1A L	700-800 HV

Zinc is an electrodeposited lightweight plating that gives a sacrificial protection to underlying substrates (carbon steel). This method lays a thin layer of zinc over the surface meaning the zinc plating would corrode in preference to the substrate and therefore protecting the covered steel product.

Salt Spray (hrs)		
Thickness and Passivation	White Rust	Red Rust
5µ Trivalent Clear	6	24

Size & Part Numbers

LENGTH GAUGE	M5	M6	M8	M10	M12
STOCK	NG05T2	NG06T2	MG08T2	MG10T2	MG12T2

Additional Information

Installation: Nogo™ - see video

Removal: 1-Way Removable Screw



Every effort has been made to ensure the accuracy of information provided in this catalogue. Hafren Fasteners cannot warrant the information however, expressly or implied, and any liability arising from it is expressly excluded. Customers must satisfy themselves as to the suitability of products and the technical information relating to them, and it is recommended that you conduct your own tests to establish suitability. All sizes shown are in mm without min and max tolerances and are guide sizes. Hafren Fasteners reserve the right to change/alter sizes without notice. This does not effect your statutory rights.