

2 Hole - Raised Countersunk Machine Screw - A2 Stainless Steel

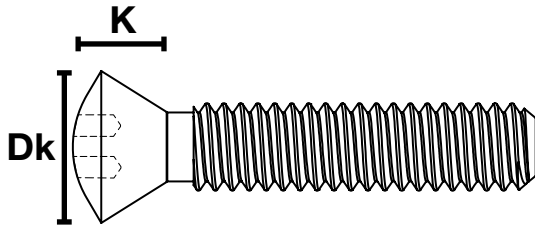

Dimensions (mm) | Part Numbers

BOX QTY 100

| LENGTH DIAMETER Thread Pitch | Dk | K | 12mm | 25mm | 30mm | 40mm | 50mm | DRIVER SIZE |
|------------------------------------|------------|-----|------|----------|----------|----------|----------|-------------|
| | M3.5 x 0.6 | 5.5 | 1.7 | THRM3512 | THRM3525 | THRM3530 | THRM3540 | THRM3550 |

Material and Finish

Material: A2 Stainless Steel
Heat Treatment: None
Finish: Passivated

A2
Stainless
Steel

Additional Information

Installation: 5-Lobe Pin - see video
Removal: 2-Way Removable Screw



Every effort has been made to ensure the accuracy of information provided in this datasheet. Hafren Fasteners cannot warrant the information however, expressly or implied, and any liability arising from it is expressly excluded. Customers must satisfy themselves as to the suitability of products and the technical information relating to them, and it is recommended that you conduct your own tests to establish suitability. All sizes shown are in mm without min and max tolerances and are guide sizes. Hafren Fasteners reserve the right to change/alter sizes without notice. This does not effect your statutory rights.